

10402-2001 Watermain Layout
 10402-2004 Drainage Layout
 10402-2006 Roads Layout

10402-2003 Watermain Layout
 10402-2005 Drainage Layout
 10402-2007 Roads Layout

Key Plan
 Scale 1:1000

Proposed Raining Main Discharge Manhole - 1W STD-WW-29

Proposed Foul Raining Main Discharge Manhole - 20 dia road Sewer Infrastructure

- NOTES:**
- WATERMAIN INFRASTRUCTURE TO BE CONSTRUCTED IN ACCORDANCE WITH IRISH WATER SPECIFICATION IWCS-02003
 - CONNECTIONS AND A FREE FLOW FROM THE KERB AND 30mm FROM ANY OTHER SERVICE (STD-W-11) ALL WATERMANS TO BE A MINIMUM OF 30mm FROM SMALL SIZE ADJUTIVE TREES AND 60mm FROM DECIDUOUS TREES (STD-W-12A)
 - WATERMAIN LAYOUT SHALL BE TO 20mm FROM TREES WITH ROOT PROTECTION. TREES TO BE NO GREATER THAN MEDIUM SIZE AS PER IWCS-02003 E.G. ASH, WHITEBARK OR SIMILAR.
 - WATERMANS TO BE KEPT 25mm TO 20mm FROM TREES WITH NO ROOT PROTECTION. TREES TO BE NO GREATER THAN MEDIUM SIZE AS PER IWCS-02003 E.G. ASH, WHITEBARK OR SIMILAR.
 - LOCATION OF VALVES, MANHOLES, HYDRANTS ARE SHOWN INDICATIVE ONLY ON THIS DRAWING. IT IS THE CONTRACTOR'S RESPONSIBILITY TO ENSURE THAT THE POSITIONS ON THE GROUND ARE IN ACCORDANCE WITH IWCS-02003

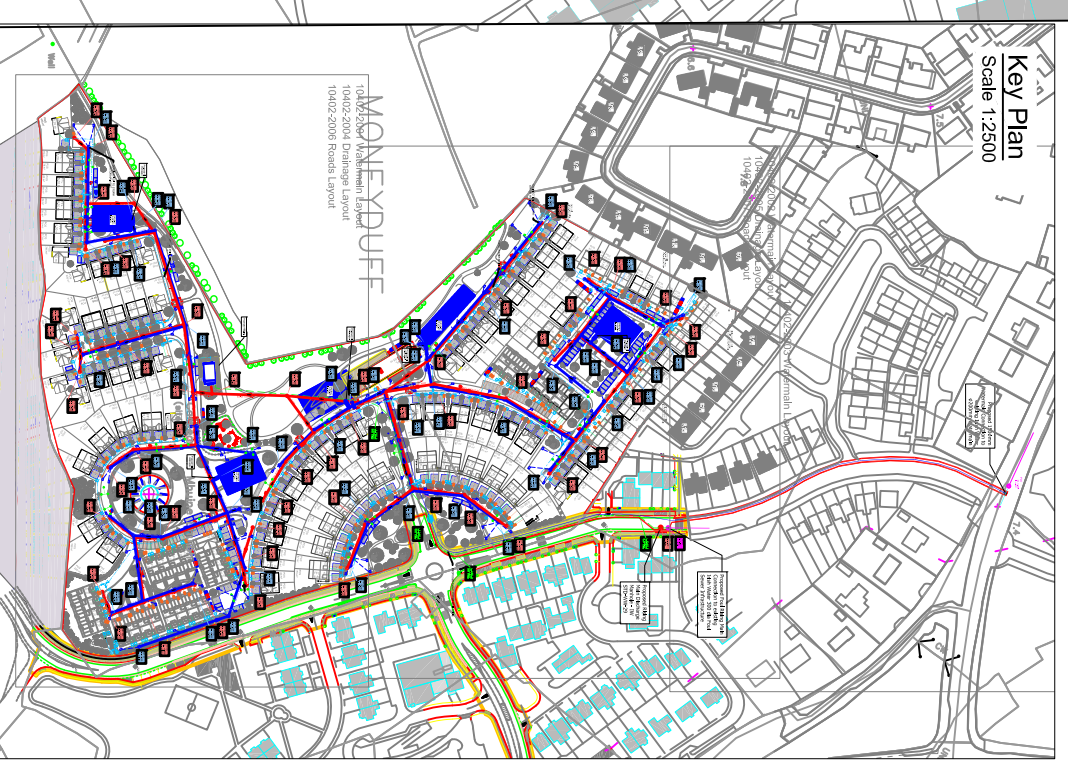
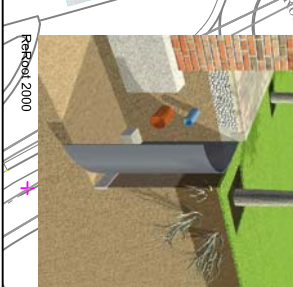

Key Plan
 Scale 1:2500

10402-2001 Watermain Layout
 10402-2004 Drainage Layout
 10402-2006 Roads Layout

NOTES:

- FIGURED DIMENSIONS ONLY TO BE TAKEN FROM THIS DRAWING.
- ALL DRAWINGS TO BE CHECKED BY THE CONTRACTOR ON SITE.
- ENGINEER/EMPLOYERS REPRESENTATIVE, AS APPROPRIATE, TO BE INFORMED BY THE CONTRACTOR OF ANY DISCREPANCIES BEFORE ANY WORK COMMENCES.
- THE CONTRACTOR SHALL UNDERTAKE A THOROUGH CHECK FOR THE ACTUAL LOCATION OF ALL SERVICES BEFORE ANY WORK COMMENCES.
- ALL ELEVATIONS SHOWN RELATIVE TO ORDNANCE SURVEY DATUM AT MAIN HEAD.

LEGEND

- Proposed Foul Sewer and Manhole
- Proposed Storm Sewer and Manhole
- Proposed Raining Main Manhole
- Proposed Road Gully Location and 100mm Connection
- Proposed Raining Main Manhole
- Proposed Sewer Connection and Inspection Chamber
- Proposed Raining Main
- Proposed Pumping Station
- Proposed Watermain
- Existing Watermain
- Existing Foul Sewer and Manhole
- Proposed Level
- Proposed Site Boundary/Megafence
- Proposed 25mm House Connections

Client: ARLUM LTD.

Project: Residential Development Moneyduff, Oranmore Co. Galway

Scale @ A1: As Shown

Prepared by: JK
Checked: BR
Date: January 2018

Project Director: Michael McDonnell

Drawing Status: Planning

TOBIN
 Patrick J. Tobin & Co. Ltd.
 Tobin Consulting Engineers,
 Fairgreen House, Fairgreen Road,
 Galway, Ireland.
 Tel: +353-(0)91-863211
 Fax: +353-(0)91-863288
 Email: galway@tobin.ie
 WWW.TOBIN.IE

Drawing No.: 10402-2000
Revision: E